



1802/30 Glen Street Milsons Point NSW

2 🛏 2 🚿 2 🚗

Embracing peaceful views across Lavender Bay and beyond, this contemporary apartment captivates a sophisticated lifestyle. Enjoying its attractive corner position and a unique family-friendly floor plan.

View : <https://www.milsonre.com/lease/nsw/north-shore-lower/milsons-point/residential/apartment/5930820>

The sought after Colonnades complex offers great convenience from the heart of Milsons Point, with resort style facilities including a gym, pool, spa, sauna and 24 hour concierge.

Surrounded by scenic foreshore walks and only footsteps to award-winning eateries and lifestyle amenities.

- Fantastic condition, well-proportioned floor plan
- Large, wrap-around living area with floor-to-ceiling windows
- Galley kitchen with gas cooking, stone benchtops and

STORAGE



TANDEM SECURE PARKING

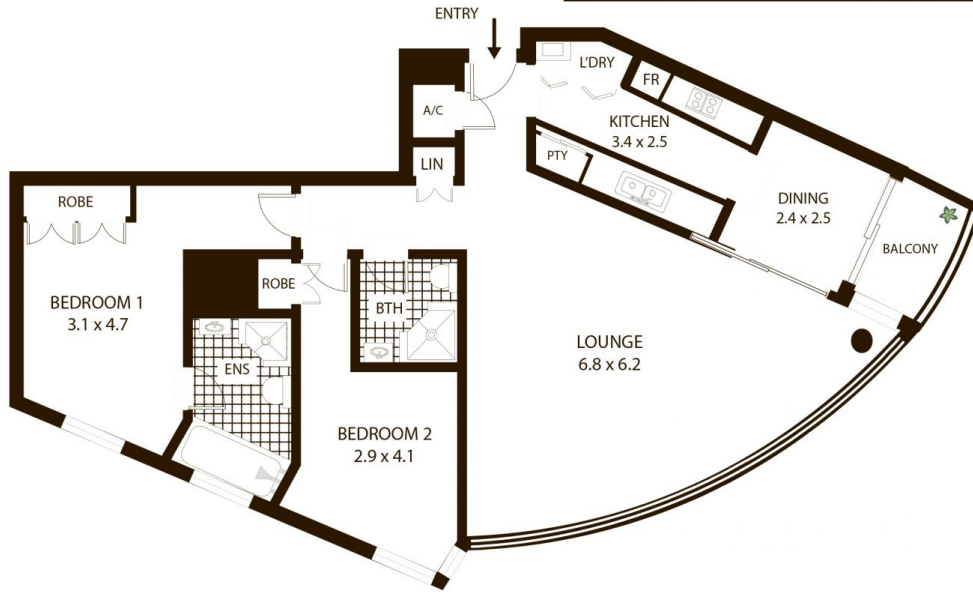
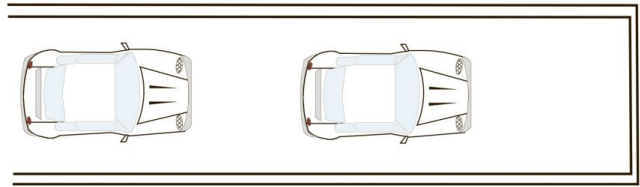

1802/30 Glen St, Milsons Point

All measurements are approximate only. Plan is provided as an indication of layout

