



**Level 3/9/211 Pacific Highway North Sydney NSW**

1 🏠 1 🚗

Stylishly appointed to soften the stress of the executive lifestyle, this unique home enjoys pleasant character without compromising on convenience. Appealing to those with an eye for detail, this third floor position carries an enviable layout and outlook within the sought after resort inspired Skye complex.

- Attractive floor plan with world class fittings and fixtures
- World class kitchen with Smeg gas cooking, good storage and stone benchtop
- Generous bathroom with contemporary design
- Peaceful east facing balcony and dining area
- Sought after security complex with roof top common facilities
- Available to view as advertised or by appointment
- (car parking in building also available to lease on attractive terms)

**View :** <https://www.milsonre.com/sale/nsw/north-shore-lower/north-sydney/residential/apartment/6463331>



**Chris Bell**  
02 9007 5300



**Matt Scoble**  
0412 158 825

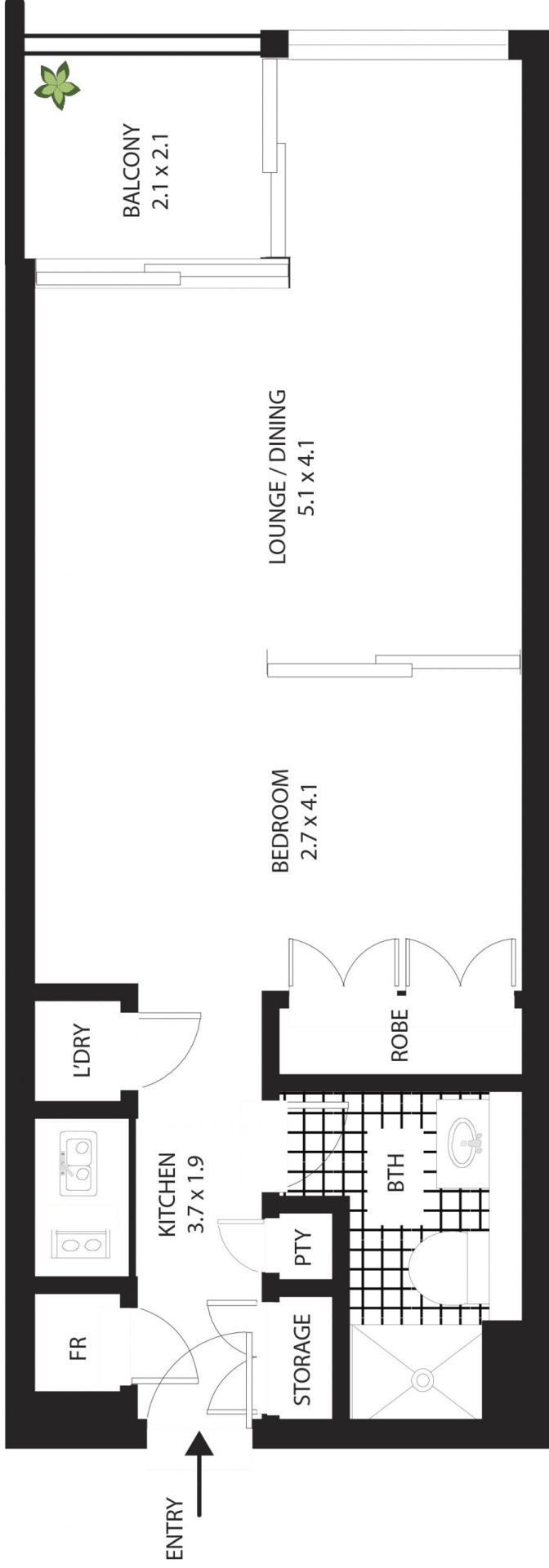

NOTE: ADDITIONAL PRIVATE STORAGE CAGE



# 309/211 Pacific Hwy, North Sydney

All measurements are approximate only. Plan is provided as an indication of layout