



13/50-60 Clark Road North Sydney NSW

3 2 2

Tastefully presented with contemporary finishes throughout, this expansive double brick townhouse is peacefully positioned on the fringe of Kirribilli and Neutral Bay, close to Anderson Park and Sydney Harbour foreshore. Offering multiple living zones including a flexible loft retreat, formal living area and attic home-office, plus an impressive open kitchen & dining area flowing to a tranquil sun filled courtyard, this quality low-maintenance home provides an exceptional lifestyle with incredible living space.

- 239sqm on title, including a large sun-filled entertainer's courtyard
- Stunning marble kitchen with gas cooking, and plenty of storage
- Open dining with timber flooring flowing through to courtyard with BBQ & outdoor dining

Price : \$ 2,500,000
Land Size : 239 sqm
View : <https://www.milsonre.com/sale/nsw/north-shore-lower/north-sydney/residential/townhouse/7671477>



Chris Bell
02 9007 5300



Phil Bell
02 9007 5300

BASEMENT LEVEL

SECURE TANDEM PARKING
2.8 x 8.6

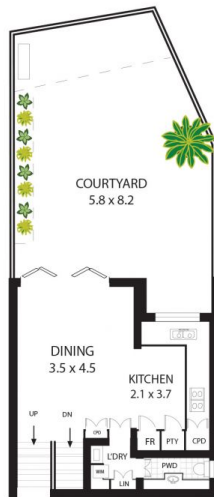
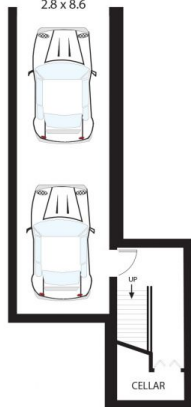

LOWER LEVEL

MID LEVELS

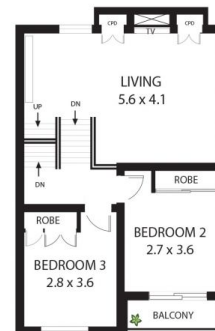
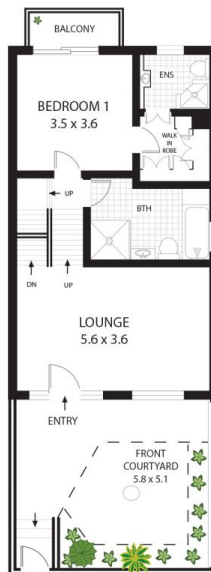

UPPER LEVELS

ATTIC LEVEL



13/50-60 Clark Rd, North Sydney

All measurements are approximate only. Plan is provided as an indication of layout

0 1 2 3 M
SCALE

